

Plat of Survey

of

Tax Parcels KLF 2000009 & KLF 2100007,

located in the Southeast 1/4 of the Southeast 1/4 of Section 20 and the Northwest 1/4 and the Southwest 1/4 of the Southwest 1/4 of Section 21, all in Town 3 North, Range 17 East, Town of Lafayette, Walworth County, Wisconsin.

A parcel of land described in a Wisconsin Special Warranty Deed recorded August 20, 2014 as Document No. 890197 as shown below:

The South 30 acres of the SE 1/4 of the SE 1/4 of Section 20 and the West 1/2 of the W 1/2 of the SW 1/4 of Section 21, all in Township 3 North, Range 17 East of the 4th P.M., Town of Lafayette, Walworth County, Wisconsin.

Excepting therefrom Certified Survey Map No. 4574, recorded in Vol. 30 of Certified Survey Maps of Walworth County on Page 67 and located in the Northeast 1/4 of the Northeast 1/4 of Section 31, Town 4 North, Range 16 East, Town of LaGrange, Walworth County, Wisconsin.

Prepared for: **Norman L. & Jean A. Brummel Trust**

5664 State Highway 11
Elkhorn, Wisconsin. 53121



Bearings referenced to the North line of the Southwest 1/4 of Section 21-3-17, recorded as N89°44'44"E in the Wisconsin State Plane Coordinate System, South Zone, (NAD-27).

Coordinates are referenced to the Wisconsin State Plane Coordinate System, South Zone, (NAD-27).

East 1/2 of the
Southeast 1/4 of
Section 20-3-17
81.052 Acres
(80 Acres)

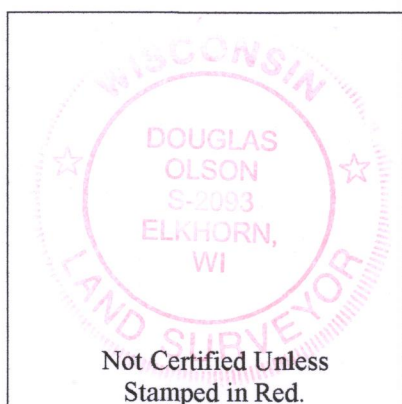

Notes:

- 1) This Plat of Survey is not certified unless signed and sealed in red ink.
- 2) This survey is subject to Wisconsin lien laws. This Plat of Survey is the notice of intent to file lien. Lien waiver required.
- 3) The Survey Date shown on this Plat of Survey is the completion date of the field work.
- 4) Wetlands are shown as flagged by McConnell Environmental, LLC.

Tax Parcel
KLF 2000008A

N89°28'03"E 1333.42'

Tax Parcel
KLF 2000007

Tax Parcel KLF 2000009

30.364 Acres
1,322,665 Sq.Ft.
(30 Acres)

Wetland
1.201 Acres
52,302 Sq.Ft.

Tax Parcel
KLF 2900001

Copyright © 2017 by Olson Land Surveying, LLC.

All rights reserved. No part of this survey plat may be reproduced or transmitted in any form by any means - graphic, electronic, or mechanical, including photocopying, tracing, or information storage and retrieval systems - without permission in writing from Douglas G. Olson, Olson Land Surveying, LLC.

45 South Wisconsin Street | P.O. Box 322
Elkhorn, Wisconsin. 53121
Telephone: (262) 723-3434
Facsimile: (262) 723-8044
Email: doug@olsonsurveying.com
Website: www.olsonsurveying.com

Potter Road (66' Wide)

N89°44'44"E 331.72'

West 1/4 Corner
Section 21-3-17.
N. 261,032.34
E. 2,402,313.87

Lot 1
C.S.M. 4574

Tax Parcel
KLF 2100005A1

House
W4057

Wetland
0.451 Acres
19,624 Sq.Ft.

Tax Parcel KLF 2100007

35.199 Acres
1,533,278 Sq.Ft.
34,948 Acres
1,522,336 Sq.Ft.
Exclusive of R.O.W.

Tax Parcel
KLF 2100005A

Wetland
1.777 Acres
77,411 Sq.Ft.

Wetland
0.153 Acres
6,655 Sq.Ft.

Tax Parcel
KLF 2800005

I hereby certify that I have surveyed the above described property in compliance with Chapter A-E 7 of the Wisconsin Administrative Code and that the map hereon is correct to the best of my knowledge and belief.

Douglas G. Olson
Wisconsin Professional Land Surveyor - 2093

Sheet 1 of 1 Sheets

Drawing Name:

Job Reference Number
2015.114

Legend of Symbols & Abbreviations

- Found County Section Corner
- Found Iron Pipe
- Found Iron Rod
- Set Iron Pipe, 1" dia.
- Recorded Information
- Utility Pedestal
- Concrete Cover
- Asphalt Surface
- Concrete Surface
- Gravel Surface
- Wetland Flag

N North
S South
E East
W West
In Bearings
° Degrees
' Minutes
" Seconds
In Distances
Feet
Inches



Scale in Feet
1" = 150'



Survey Date: January 10, 2018.

Revisions:
KLF20-9 317-1077
KLF21-7

1A4574-1